

PROPOSED SITE PLAN FOR CONSTRUCTION OF G+3 STORIED EDUCATIONAL BUILDING OF J.B.MEMORIAL COLLEGE OF EDUCATION ORGANISED BY BINPUR RURAL WELFARE SOCIETY ON PLOT NO.- 1226 / 1838, 1226 / 1839, 1226 / 1840, KHATIAN NO.- 1262, AT KUI MOUZA, J.L.NO.-447 , KUI , BINPUR-1 G.P. BINPUR P.S., DIST.- PASCHIM MEDINIPUR, STATE - WEST BENGAL .

TOTAL PLOT AREA= 0.93 ACRE = 3763.51 SQM. = 40495.37 SQ. FT.
 TOTAL BUILDING COVERED AREA= 1011.56 SQM. = 10884.39 SQ. FT.

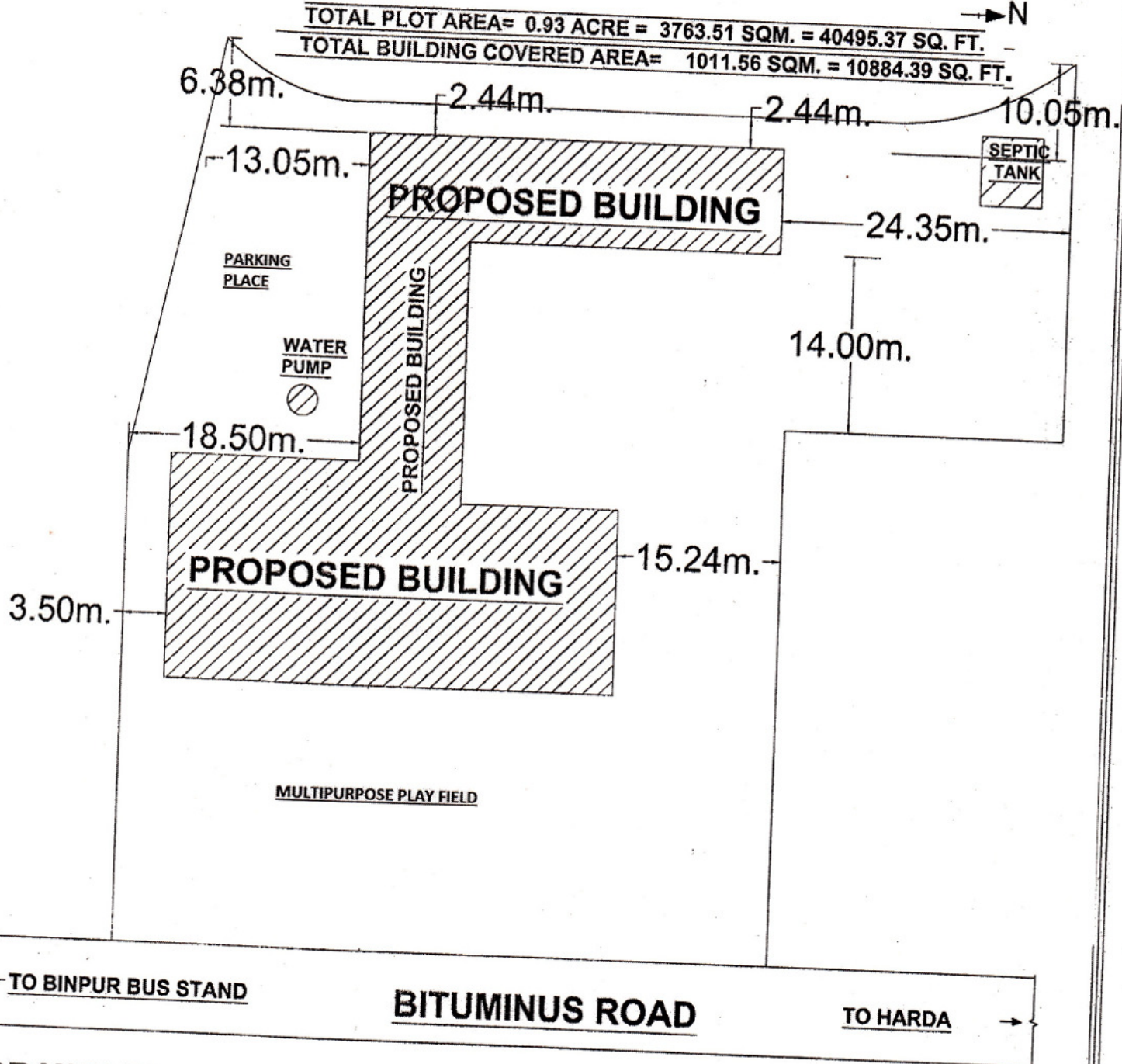

DRAWN BY :-

SIGN. OF AUTHORITY :-

OFFICE USE :-

K.C.D. 3.4.15
K. C. DAS, Civil Engineer
 Dakshin Kalapunja, Naya Pingla,
 Paschim Medinipur

A. Janta
Chairman 1-5-17
 J.B. Memorial College of Education
 KUI, BINPUR, PASCHIM MEDINIPUR (W.B.)

[Signature] 13.5.17
Block Land & Land Reforms Officer
 Binpur-1, Paschim Medinipur